

# DIGITRON SEMICONDUCTORS

## MECHANICAL CASE OUTLINE PACKAGE DIMENSIONS

DATE 29 DEC 2017

### DO-4R STUD

<b>CASE</b>	HERMETICALLY SEALED METAL AND GLASS
<b>MARKING</b>	ALPHA NUMERIC
<b>POLARITY</b>	ANODE IS STUD
<b>WEIGHT</b>	7.5 GRAMS (APPROXIMATE)

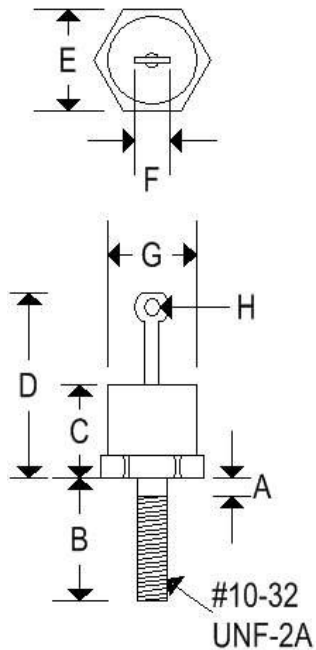

	DO-4R			
	Inches		Millimeters	
	Min	Max	Min	Max
A	-	0.078	-	1.981
B	0.422	0.453	10.719	11.506
C	-	0.405	-	10.287
D	-	0.800	-	20.320
E	0.420	0.440	10.668	11.176
F	-	0.250	-	6.350
G	-	0.424	-	10.770
H	0.066	-	1.676	-

This drawing is for reference only. Please refer to Digitron's published datasheet.